



# TIME030

## MISTURADORA DUCHE TIMELESS

**EN** SHOWER MIXER TIMELESS

**FR** MÉLANGEUR DOUCHE TIMELESS

**ES** MEZCLADOR DUCHA TIMELESS



**A S M T A P S**®

W A T E R S O U L

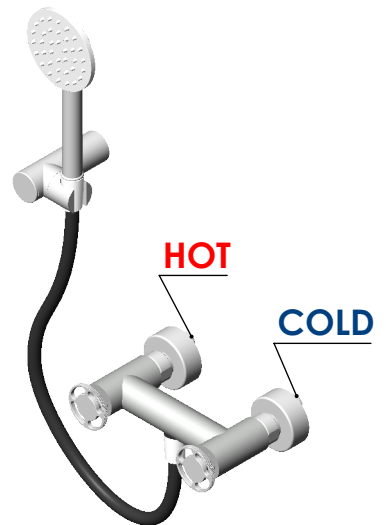
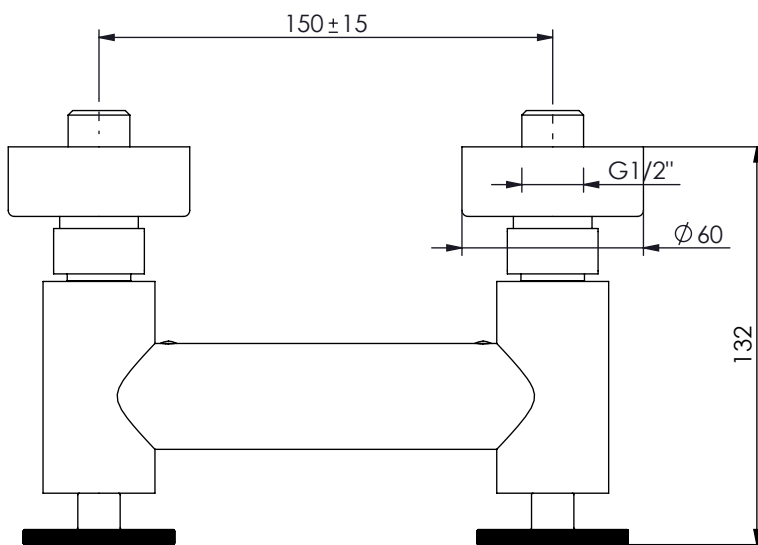
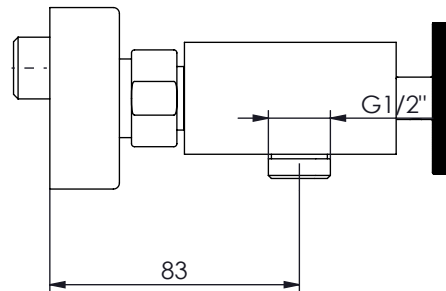
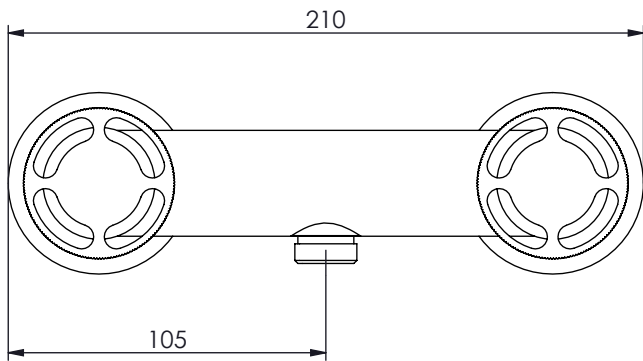

Rev.00  
TIME030



### CARACTERÍSTICAS TÉCNICAS

PRESSÃO RECOMENDADA: RECOMMENDED PRESSURE:	3 - 4 BAR
TEMPERATURA RECOMENDADA: RECOMMENDED TEMPERATURE:	15°C - 65°C
MATERIAIS: MATERIALS:	Latão
TEMPERATURA MÁXIMA: MAXIMUM TEMPERATURE:	70°C
CAUDAL MÁXIMO A 3 BAR: MAXIMUM FLOW AT 3 BAR:	5L/MIN
LIGAÇÃO DE ENTRADA: INPUT CONNECTION:	G1/2"
LIGAÇÃO DE SAÍDA: OUTPUT CONNECTION:	G1/2"
PESO (KG): WEIGHT (KG):	1,97
DIMENSÕES EMBALAGEM (MM): SIZE PACKAGING (MM):	285x200x170

### ACABAMENTOS

CR - CROMADO   CHROME   CHROME   CROMO
PR - PRETO MATE   BLACK MATT   NOIR MAT   NEGRO MATE
BR - BRANCO MATE   WHITE MATT   BLANC MAT   BLANCO MATE
ST - SATINOX   SATINOX   SATINOX   SATINOX
AT - ANTRACITE   ANTHRACITE   ANTHRACITE   ANTRACITA
GM - GUNMETAL   GUNMETAL   GUNMETAL   GUNMETAL
GMM - GUNMETAL MATE   GUNMETAL MATT   GUNMETAL MAT   GUNMETAL MATE
OR - DOURADO   GOLD   DORÉ   DORADO
ORM - DOURADO MATE   GOLD MATT   DORÉ MAT   DORADO MATE
CB - COBRE   COPPER   CUIVRE   COBRE
CBM - COBRE MAT   COPPER MAT   CUIVRE MAT   COBRE MATE

### TECNOLOGIA

-  AC1360 - Castelo Cerâmico  
AC1360 - Ceramic Valve
-  Suporte de chuveiro cilíndrico  
Cylindrical abs wall shower support
-  Chuveiro mão cilíndrico latão  
Round Brass Hand Shower
-  Ligaçao Banheira/duche 1,70mt silicone  
Silicone bath/shower hose 1,70mt